

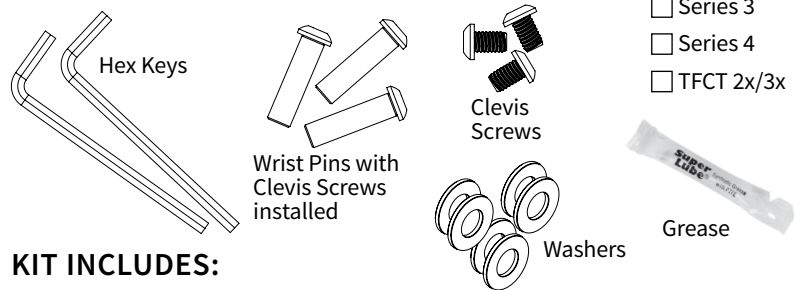

720 S 850 East Lehi, Utah 84043, USA
 1-888-777-5557
 www.ReallyRightStuff.com

APEX CONVERSION KIT



KIT INCLUDES:

Apex.....	1
Hex Keys	5/32" (Series 1), 3/16" (Series 2 & 3) or 7/32" (Series 4), 2 each
Wrist Pin with Clevis Screw permanently installed	3 sets
Clevis Screw with multi-use threadlock patch	3
Brass Washers (2 per leg).....	6
SuperLube® Synthetic Grease with PTFE	1cc

- Series 1
- Series 2
- Series 3
- Series 4
- TFCT 2x/3x

EXPLODED VIEW OF APEX

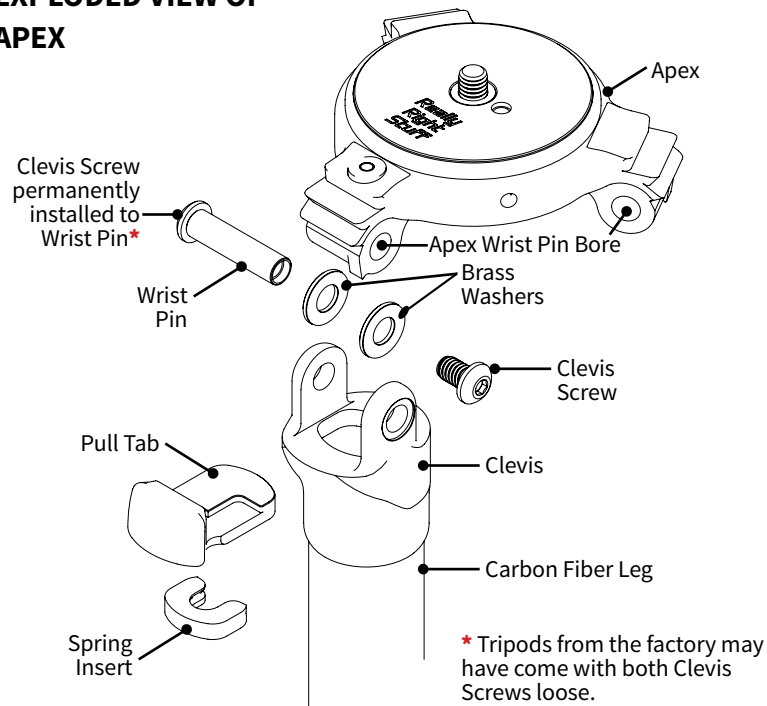

STEP 1: Remove tripod legs

Use hex keys as shown to unscrew both Clevis Screws simultaneously. Expect resistance; they were installed with threadlocker fluid at the factory. Unscrew simultaneously until they can be completely removed. If Screws come out but Wrist Pin remains in the joint, use your fingers to lightly thread one of the screws back into the Wrist Pin. Insert a hex key into the other end of the Wrist Pin and tap it to push the Wrist Pin free of the Apex.

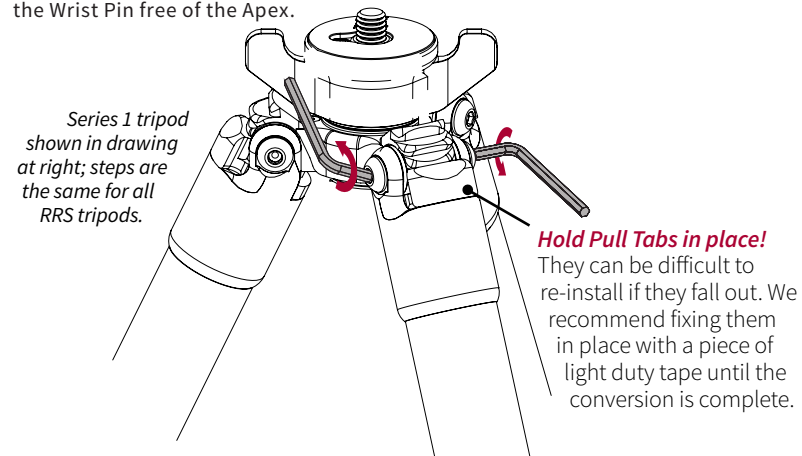

STEP 2: Apply grease

Apply grease **sparingly** in two places:
to the Wrist Pin, and on **both sides** of the axle hole in the new apex.



STEP 3: Install tripod legs

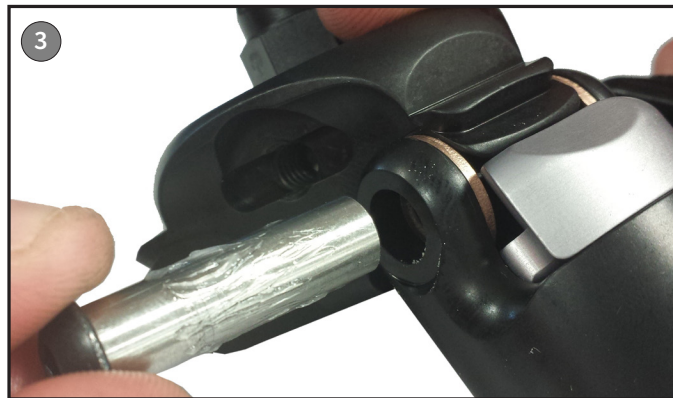
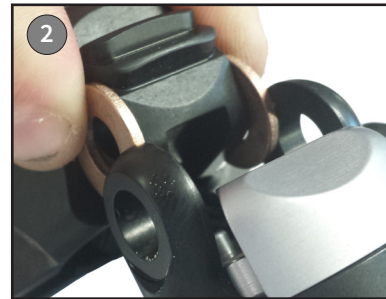

STEP 4: Tighten axle bolts

Leg bolts should be tight enough to prevent legs from collapsing, but loose enough to open with ease. Use hex keys as shown to tighten the bolts.

